

# Flow monitor for liquid and pasty media



## flow-captor 4114.70

The flow-captor 4114.70 is a universally applicable solid-state flow monitor in cylindrical housing for industrial applications. The construction and design of this flow-captor makes application ideal even in inaccessible places and harsh environmental conditions. The flow-captor operates according to the calorimetric principle without any moving parts. Installation by means of a stainless steel union nut is simple and allows fitting in any pipe assembly. The construction of the sensor provides for non-intrusive flow sensing and does not obstruct the pipe diameter.



- Precise switching flow monitor for liquid and pasty media.
- Set-point adjustable from 0,2 m/s to 2 m/s relating to medium water
- New calorimetric principle without moving parts
- LED-display for output status
- **ISO 9001 : 2008**

| Technical Data                 |   |
|--------------------------------|---|
| Typ                            | <b>4114.70</b>  |
| Medium                         | Liquid and pasty media (aggressive media on request)                |
| Sensor Data *1                 |   |
| Measuring range                | 0,2 m/s to 2 m/s, continuously adjustable                           |
| Adjustment characteristics     | Logarithmic to flow speed   |
| Medium temperature             | - 10°C to + 80°C  |
| Ambient temperature            | - 10°C to + 60°C  |
| Pressure                       | Max. 30 bar   |
| Response time                  | 2 - 10 s depends on measuring conditions                            |
| Repeatability                  | < 5%  |
| Temperature drift              | < 0,5% / K  |
| Hysteresis                     | < 15%   |
| Mechanical Data                |   |
| Protection class               | IP65  |
| Material housing / sensor      | stainless steel WN 1.4305 / AISI 303 (other material on request)    |
| Material of sensor probe       | FP (Viton)  |
| Mounting accessories           | Union nut G 1 ¼" A, SW 50 mm (stainless steel WN 1.4305 / AISI 303) |
| Electrical connection          | 2 m moulded oilflex cable 3 x 0,5 mm <sup>2</sup>                   |
| Dimensions                     | L = 109,5 mm; B = 32 mm   |
| Electrical Data                |   |
| Operating voltage              | 24V AC/DC ±10%  |
| Current consumption            | Max. 200 mA   |
| Initial operation              | approx. 10 s after connection of power                              |
| Electrical output without flow | PNP n.o. (closer)<br>currentless                                    |
| LEDs                           | green: flow - rate > set - point<br>red: flow - rate < set point    |

\*1) data relate to water

Dimensions in mm

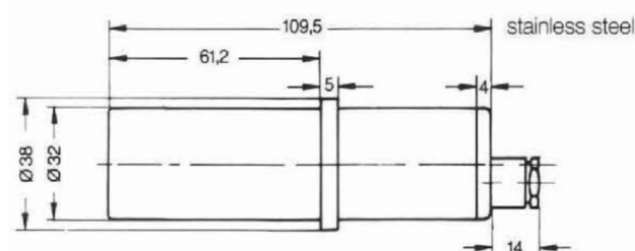
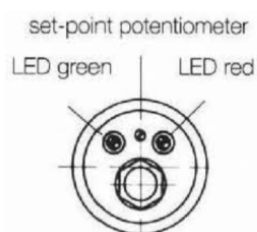

AC / DC-transistor output  
DC: NPN output

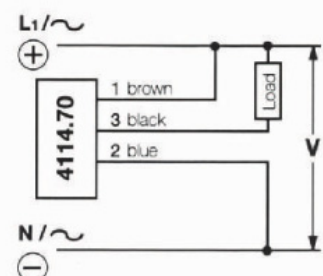

**weber**